



# Archived resources

For further resources and  
documentation please visit us:  
**[www.cinos.net](http://www.cinos.net)**

# POLY SOLUTIONS FOR MICROSOFT

**POWERING SUPERIOR  
EXPERIENCES FOR  
MICROSOFT TEAMS AND  
SKYPE FOR BUSINESS**



Microsoft  
Partner  

Gold Communications  
Gold Cloud Productivity

# WE CONNECT PEOPLE, NOT THINGS

Poly is the global communications company that powers authentic human connection and collaboration with end-to-end solutions.

“Committed to make collaboration easy for you, we have a long-term partnership with Microsoft to ensure you can achieve more. Our high-quality headsets, voice, video, and video-interop solutions work simply and flexibly with Microsoft Teams, creating a one-stop shop for all your organization’s personal and group collaboration device needs.

Poly is finding new ways to inject meaningful human-to-human cues into audio and video communication to replicate the face-to-face experience. To build intimacy. To break walls and span distance. One to one. One to many. Many to many.

Poly solutions protect your investments by enabling existing video and voice conferencing equipment to work easily with your current and future Microsoft collaboration platforms. Our Poly Professional Services team provides you with the expertise to plan, deploy, operate and support your Microsoft solution environment.

## OUR VALUE TO OUR CUSTOMERS AND PARTNERS

- **Business leaders**—More ways to improve communication and collaboration, and thus improve productivity.
- **IT managers**—More insights and interoperability that help anticipate maintenance needs, solve problems remotely, and reveal the ways users interact with their systems and work environment.
- **Business partners**—More opportunities as we work together to give our customers more of what they want.

## BEST COLLABORATION EXPERIENCE—END-TO-END

- Everywhere the communications and collaboration clouds touch the individual, we are there to provide the most human experience.
- We help you with our expertise and knowledge so you know what to focus on to ensure your success.
- We provide the management insights built on data and analytics to make it all work better, smarter, easier.

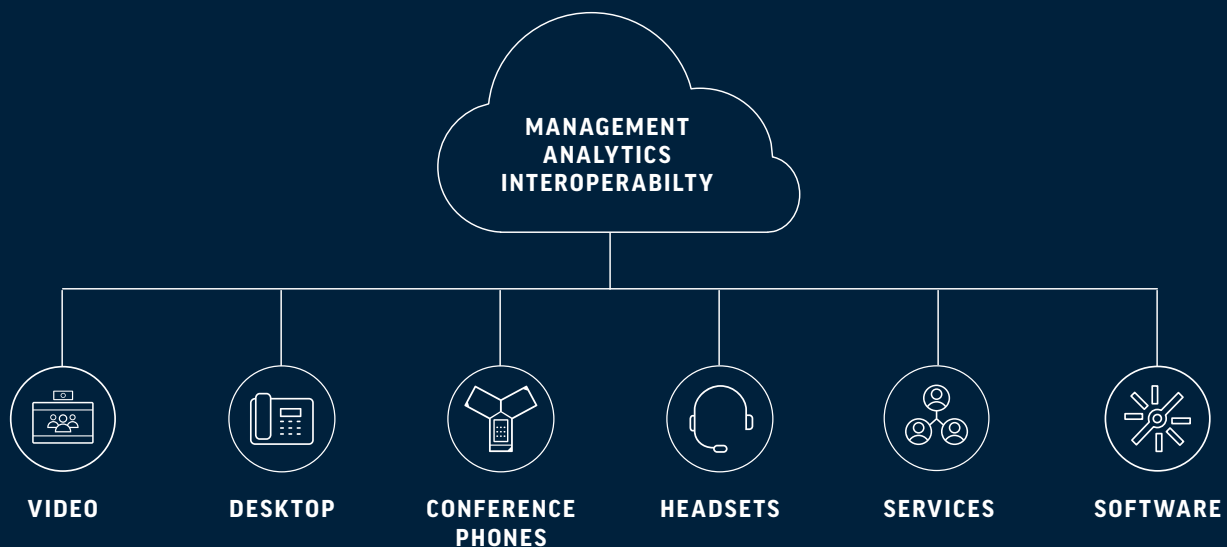



## POLY G10-T

Delivering clutter-free Microsoft  
Teams Rooms experience





# ACHIEVE MORE WITH END-TO-END SOLUTIONS FOR MICROSOFT TEAMS

## VIDEO

Poly room solutions for Microsoft Teams, including **G-series Microsoft Teams Rooms Solutions** as well as **Poly Studio X30** and **Poly Studio X50 Collaboration Bars** for Microsoft Teams, deliver the familiar Teams interface, combined with powerful Poly audio and video technologies.

Standalone USB camera options are also available, such as **EagleEye Cube USB**, **Poly Studio**, and **EagleEye Director II**. We understand one size doesn't fit all. Poly has the portfolio to help you equip every room, from the home office and executive office to huddle space to large conference rooms.

## VIDEO INTEROPERABILITY

**Poly RealConnect** enables video interoperability with Microsoft Teams without adding complexity. With RealConnect, it's easy to connect your H.323/SIP videoconferencing systems to Microsoft Teams (or Skype for Business) meetings. Keep the workflow you're used to, just add video interoperability so anyone can join the meeting from their personal clients, Microsoft Teams Rooms systems, as well as from video conferencing systems. It's that simple.



Poly G10-T



Poly G40-T



Poly G80-T



Poly Studio X30



Poly Studio X50



Poly Studio



EagleEye IV USB



EagleEye Cube USB



EagleEye Director II

## HEADSETS

Poly headsets are designed with today's business professional in mind, enabling rich audio connections no matter what your workstyle is or where you touch down.

Poly's Microsoft Teams-certified headsets meet Microsoft's audio requirements and include a dedicated Teams button to instantly invoke Microsoft Teams to the foreground for streamlined communications. Poly headsets certified for Skype for Business are recertified for Microsoft Teams, providing similar user experience.

The **Poly Voyager** family of Bluetooth wireless headsets provides seamless, multi-device connectivity for today's workforce.

The **Poly Savi** family provides a selection of DECT wireless headsets that offer best-in-class sound quality and multi-device connectivity, long-range and hands-free mobility and hours of talk time for ultimate efficiency.

The **Poly Blackwire** family gives you a broad selection of corded UC devices that deliver outstanding audio quality and reliability, ease of use and price points to meet any budget.



Voyager 5200 Office UC Series



Voyager 4200 Office UC Series



Voyager 4245 Office



Voyager 6200 UC



Voyager 8200 UC



Voyager Focus UC



Savi 8200 Office UC Series



Blackwire 8225



Blackwire 7225



Blackwire 5200 Series



Blackwire 3300 Series (-M)



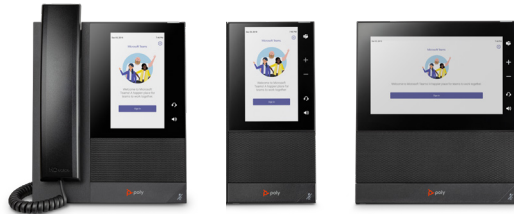

CCX Series



Elara 60 Series



Trio C60



Calisto 3200 (-M) / Calisto 5300 (-M)



Calisto 7200 (-M)

## DESKTOP

In the office, at home or on the go, Poly delivers the broadest set of voice devices for Microsoft Office 365.

**CCX Series**—our new native Microsoft Teams phones are designed to support the latest Android platforms for the most robust Teams experience today and in the future.

**Elara 60 Series** mobile phone station takes your Microsoft Teams collaboration to the next level. Seamlessly transition on-the-road calls to at-your-desk collaboration. Connect to Microsoft Teams with one touch. Stay charged and keep talking all day.

## CONFERENCE PHONES

Customers looking for phones for their Microsoft Teams communications turn to Poly when they want high-quality audio and innovative features that make a real difference.

**Trio C60**, the latest and most powerful Poly Trio conference phone to date, sets the new conferencing standard for Microsoft Teams or Skype for Business calls with familiar interface and one touch-to-join calendar integration.

**Calisto** speakerphone family turn wherever you are into a more professional-sounding space. Easy to use at home, remotely or in the office for personal and portable conferencing and small huddle rooms (Calisto 7200).

## SOFTWARE

Get a clear picture of your collaboration environments, with a spotlight on how your spaces and devices are being used. Device management puts you in control across your entire organization while the cloud-based architecture gives you security, flexibility, and agility.

**Poly Lens** provides workspace insights and management service through quick device onboarding, inventory management, and intelligent news feed.

**Plantronics Manager Pro SaaS** manages inventory effectively, drive adoption of new initiatives, and troubleshoot issues from anywhere.



## SERVICES

Our comprehensive suite of services for Microsoft Teams focuses on supporting the customer through their transformational journey, drive customer success and deliver the required business outcomes with Microsoft Teams. They provide comprehensive, personalized guidance from Poly's Microsoft experts whilst minimizing potential impact on end users and speeding up productivity.

**Poly Envisioning for Microsoft Teams** accelerates digital transformation and assists customers in achieving greater business value through the usage and adoption of Microsoft Modern Workplace Cloud Solutions.

**Poly Network Readiness Service for Microsoft Teams** ensures the network is capable of performing at a consistent, optimal level for carrying real-time media traffic, delivering a readiness assessment of connectivity from the Edge to the cloud and provides an assessment and remediation plan for improving performance in supporting the low loss, and jitter requirements needed to support real-time media.

**Poly Adoption Consulting Services for Microsoft Teams** is focused on accelerating the transition and transformation to new and better ways of working while achieving measurable business value through the usage and adoption of Microsoft Teams.

**Poly User Migration Service for Microsoft Teams** focuses on user migration for Microsoft Teams Phone System with Direct Routing and audio conferencing. The service guides the customer through the essential and complex planning, delivery, and operation activities required to successfully migrate users and workloads to Microsoft Teams.

**Poly PBX Assessment Service for Microsoft Teams** provides the tools you need to totally assess, analyze, and map the full configuration of the source PBX environment to a ready-to-execute Microsoft Teams Phone System production solution.

Or you can outsource to Poly and our **Managed Services for Microsoft Teams** offers you a turnkey solution that drives interoperability of Microsoft Teams via an end-to-end, global, single-source managed service.





To learn more about Poly solutions for Microsoft, visit [www.poly.com/microsoft](https://www.poly.com/microsoft).  
Or contact us today: [TeamMicrosoft@poly.com](mailto:TeamMicrosoft@poly.com)



For further resources and  
documentation please visit us:  
**[www.cinos.net](http://www.cinos.net)**